



SeaFeed Spreader

As the final crucial point in the feed's journey from silo to pen the SeaFeed Spreader will reliably, controllably, and gently deliver feed to your fish at low operating costs.

Robustly engineered, our spreader has an adjustable outlet nozzle which can be customised in its alignment by site operatives to suit different feed types and pen sizes thus offering a variable spread to suit individual farm feeding styles. The robust float is a fabricated rectangle design offering total stability in the water which will in turn contribute to an even distribution of feed.

Key Features

- Ensuring that pellets are handled gently is what SeaFeed is all about, and our spreader has been constructed to help do exactly this.
- Solid bearing design which can be efficiently swapped out.
- Smooth surfaces minimising fish damage
- Designed to provide an excellent, balanced spread.
- Stable, robust floating base designed to feed to your expectations in high energy conditions.

Specifications

Feed pipe diameter	90mm
Max pellet size	12mm
Recommended RPM:	50-80 RPM
Materials	Stainless steel, aluminium, poly-acetal, HDPE
Height	1140mm above water, 100mm below water
Float Dimensions	1850mm x 1600mm
Total weight	52kg
Bearing max/min temperature range	80/-40°C

Intelligently designed for long life

- A purpose-built, extremely low friction bearing with an open self-cleaning design [1]
- Easy access, quick release design with splines [2] and a stop [3] for accurate and robust placement of the feed pipe and threaded fixing holes [4] for connection to the base.
- The design incorporates sloping surfaces [5] to encourage run off of standing water, preventing build-up of debris and therefore increasing the longevity of the spreader and enhancing overall performance.

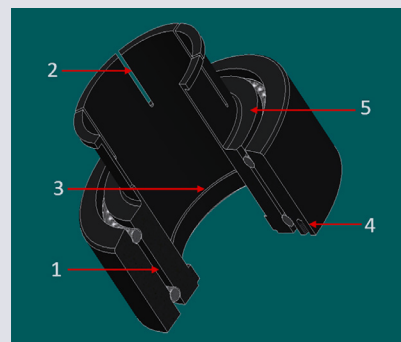

☎ +44 (0) 7720 074350
 ✉ craig.graham@gaelforcegroup.com
 🌐 gaelforcegroup.com



Reputation Built on Trust